

Dual Safety Relief Valve Assembly
 Set @ 350 PSIG
 Mounted on a 2" 3 Way
 (Removed for shipment)

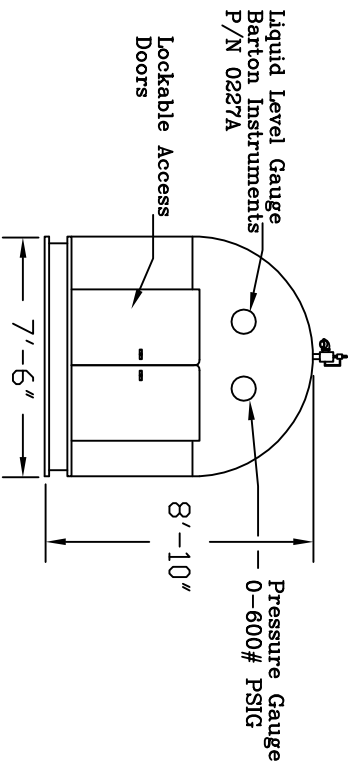
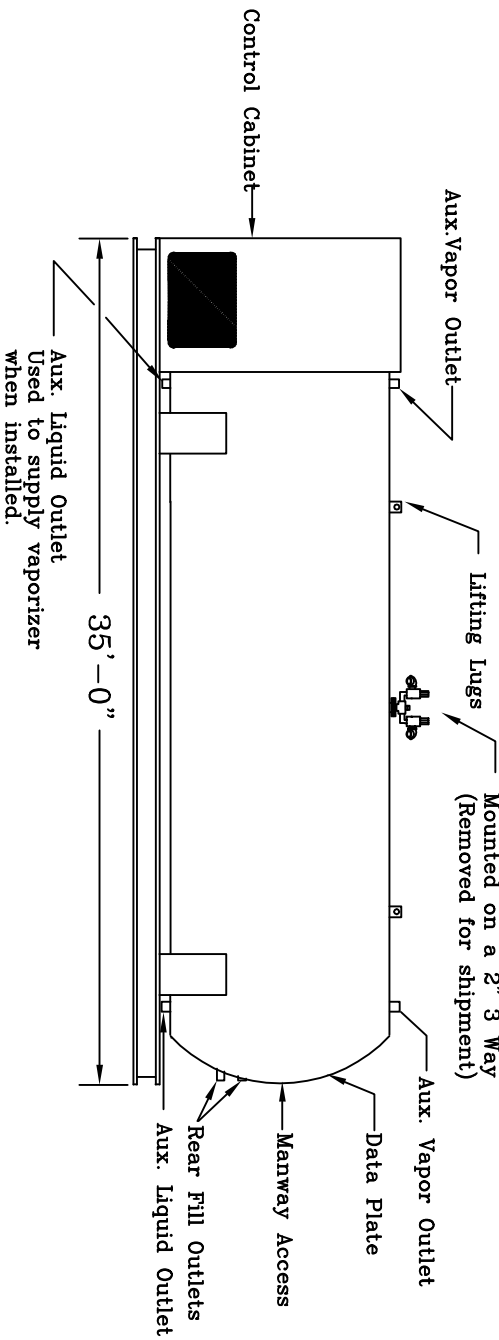

- NOTE:
- Vessel is insulated with 4" urethane insulation, then covered with .063 white aluminum.
 - Shipping wieght - 30,000#.
 - Vessel shown is for reference only. For exact vessel dimensions, see pressure vessel drawing # CAR-210-22A.

NO.	DESCRIPTION	DATE

Carbo Tech, Inc.
REPUTED
 30 Ton
 Carbon Dioxide Storage Unit
 General Outline

P.O. Box 1938 -- Morrow, Georgia 30666

DRN BY: J.W.W. SCALE: None
 CAD BY: DATE: 10.10.97

CAR-544-21